

First Floor Area = 685m² + 26m² (open west stairs)

INTERNATIONAL CENTRE FOR STURGEON STUDIES
 CHERNOFF THOMPSON ARCHITECTS

SK-02

DRAWN = NM/LP
 PROJECT NO. = 2803.0

SCALE = 1:50
 DATE = 26 MAY 09

SCHEMATIC DESIGN

4/20/09 11:52 AM 2/20/09 11:52 AM

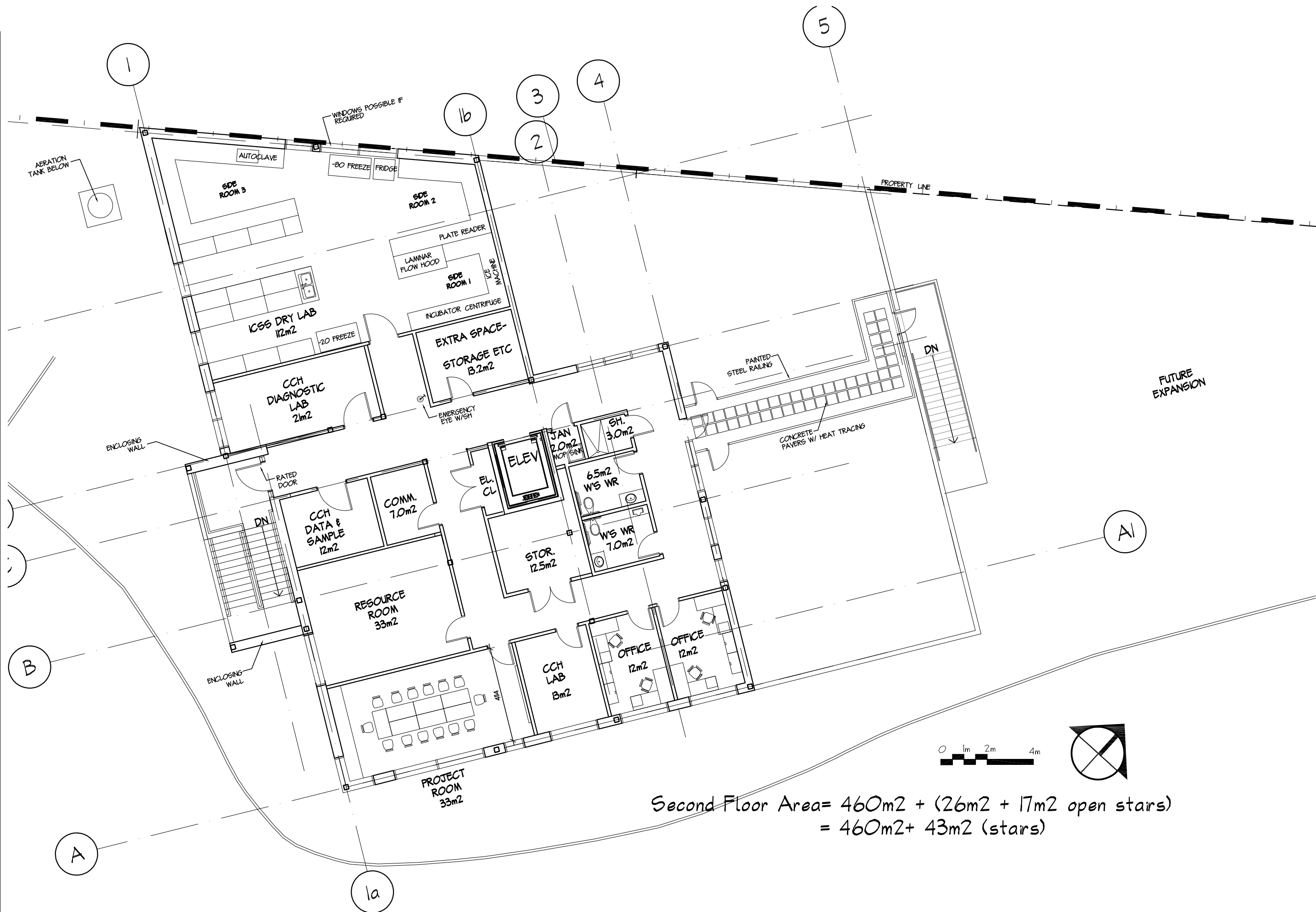

DRAWN =
PROJECT No. =

SCALE =
DATE =

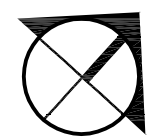
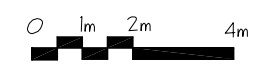

Second Floor Area = $460m^2 + (26m^2 + 17m^2 \text{ open stairs})$
 = $460m^2 + 43m^2 \text{ (stairs)}$

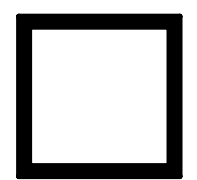

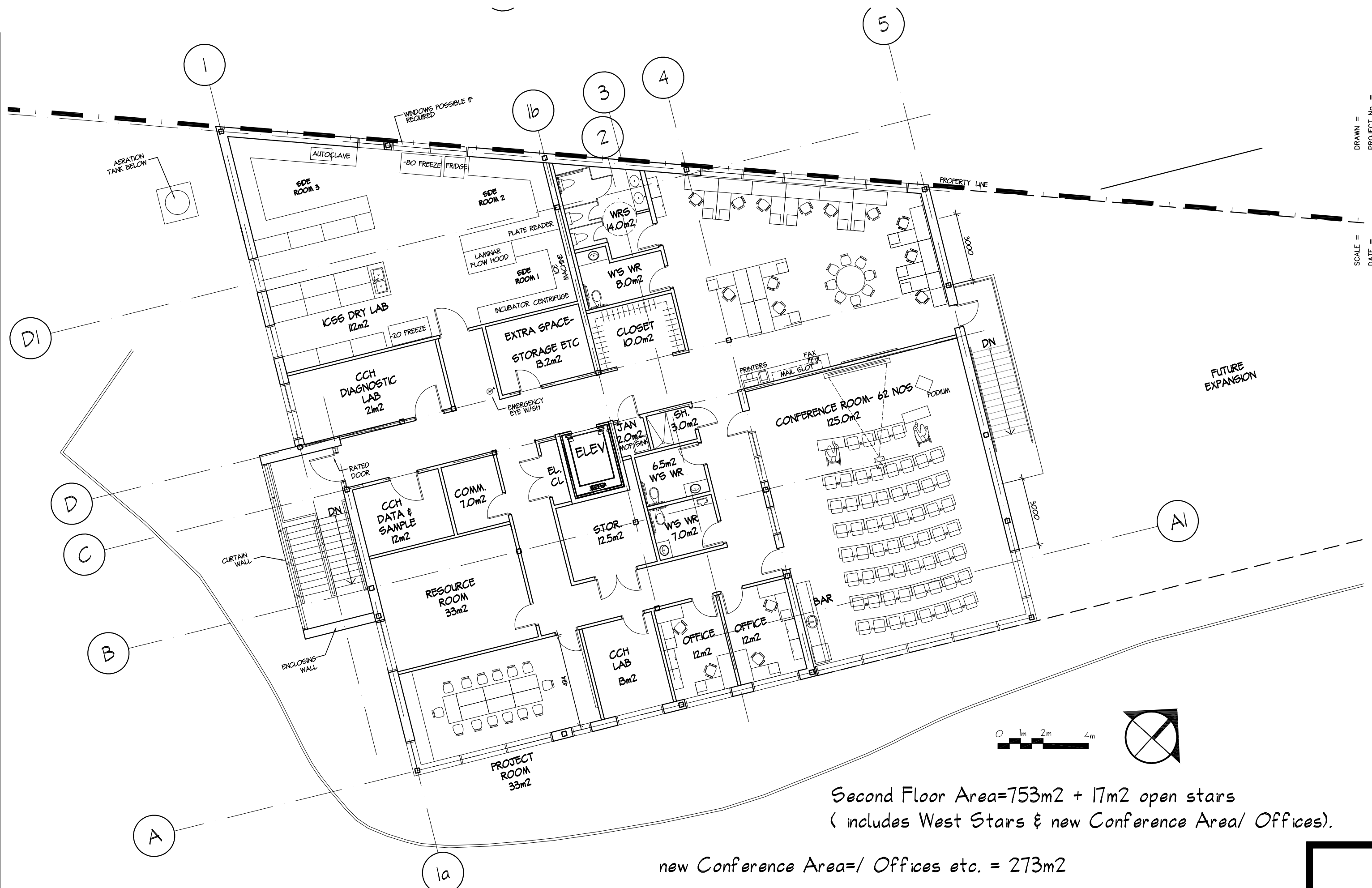

DRAWN =
PROJECT No. =
SCALE =
DATE =

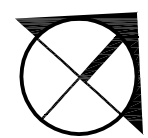
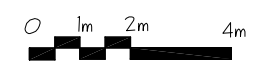

Second Floor Area=753m² + 17m² open stairs
(includes West Stairs & new Conference Area/ Offices).

new Conference Area= / Offices etc. = 273m²

