

22/09/08

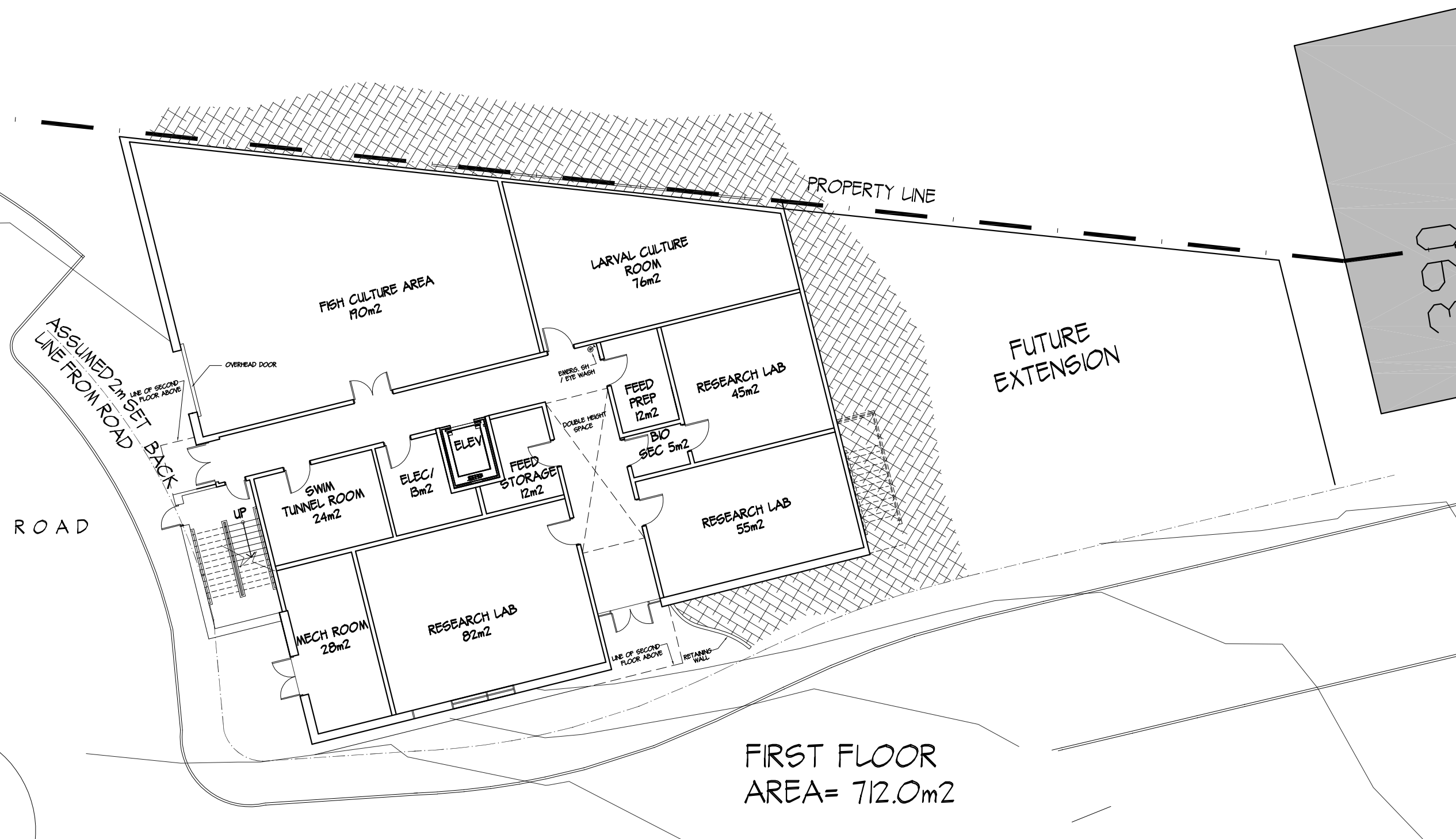

FIRST FLOOR
AREA= 712.0m²

FIRST FLOOR PLAN-OPTION A

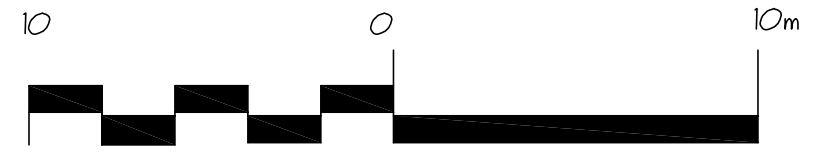

SCHEMATIC DESIGN



INTERNATIONAL CENTRE FOR STURGEON STUDIES
 CHERNOFF THOMPSON ARCHITECTS

SK-02

DRAWN = NM
 PROJECT No. = 2803.0
 SCALE = 1:200
 DATE = 08 OCT 08

420701-0001 22/09/08

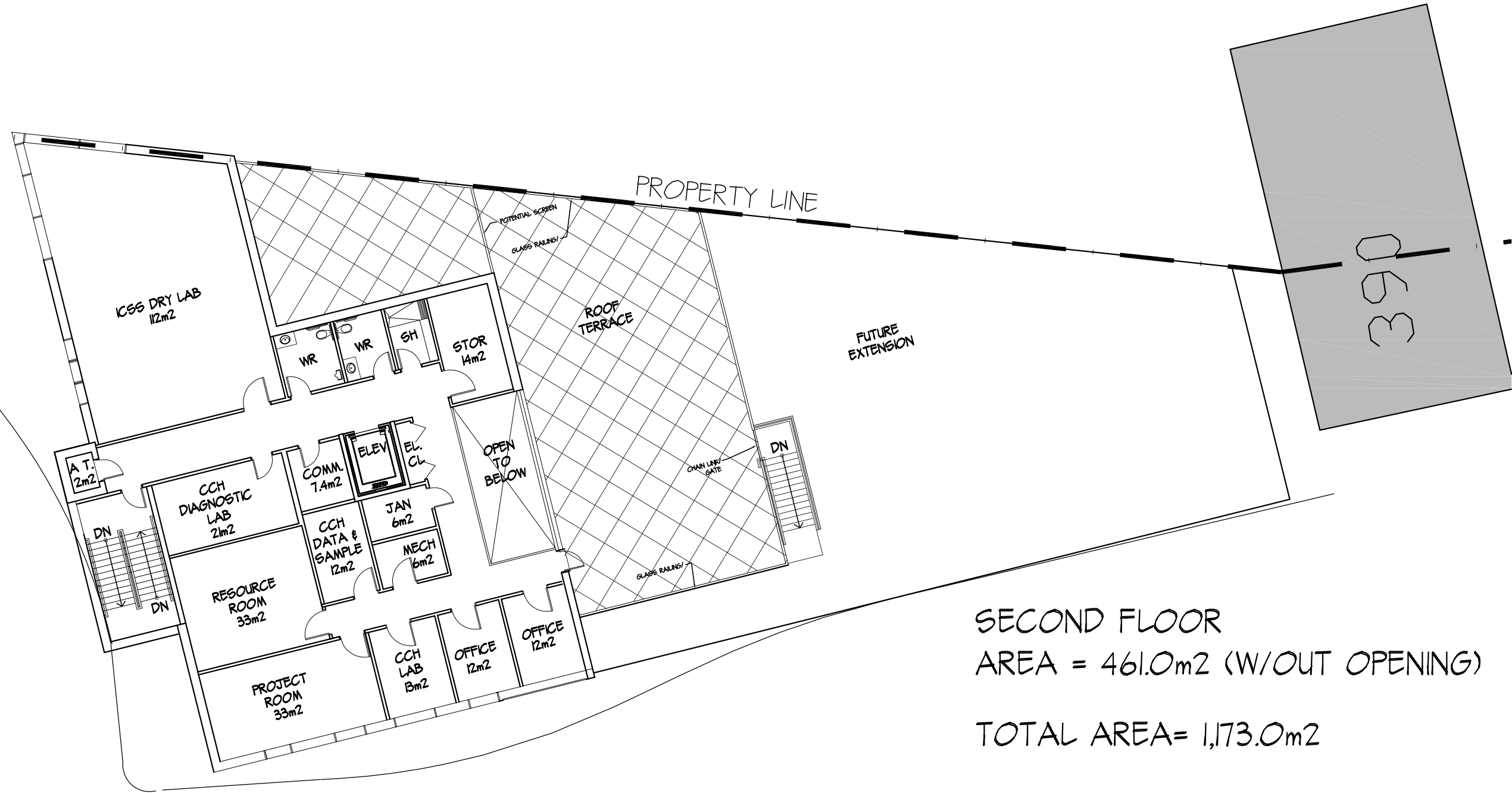

SECOND FLOOR
 AREA = 461.0m² (W/OUT OPENING)

TOTAL AREA= 1,173.0m²

SECOND FLOOR PLAN-OPTION A

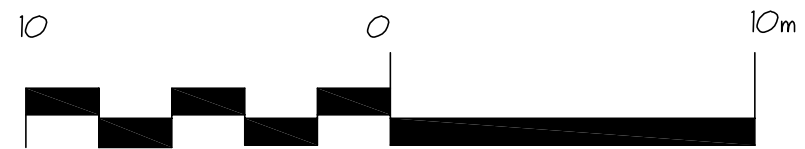

SCHEMATIC DESIGN

INTERNATIONAL CENTRE FOR SURGEON STUDIES
 CHERNOFF THOMPSON ARCHITECTS

SK-03

SCALE = 1:200
 DATE = 08 OCT 08

DRAWN = NM
 PROJECT No. = 2803.0

42074-001 22/09/08

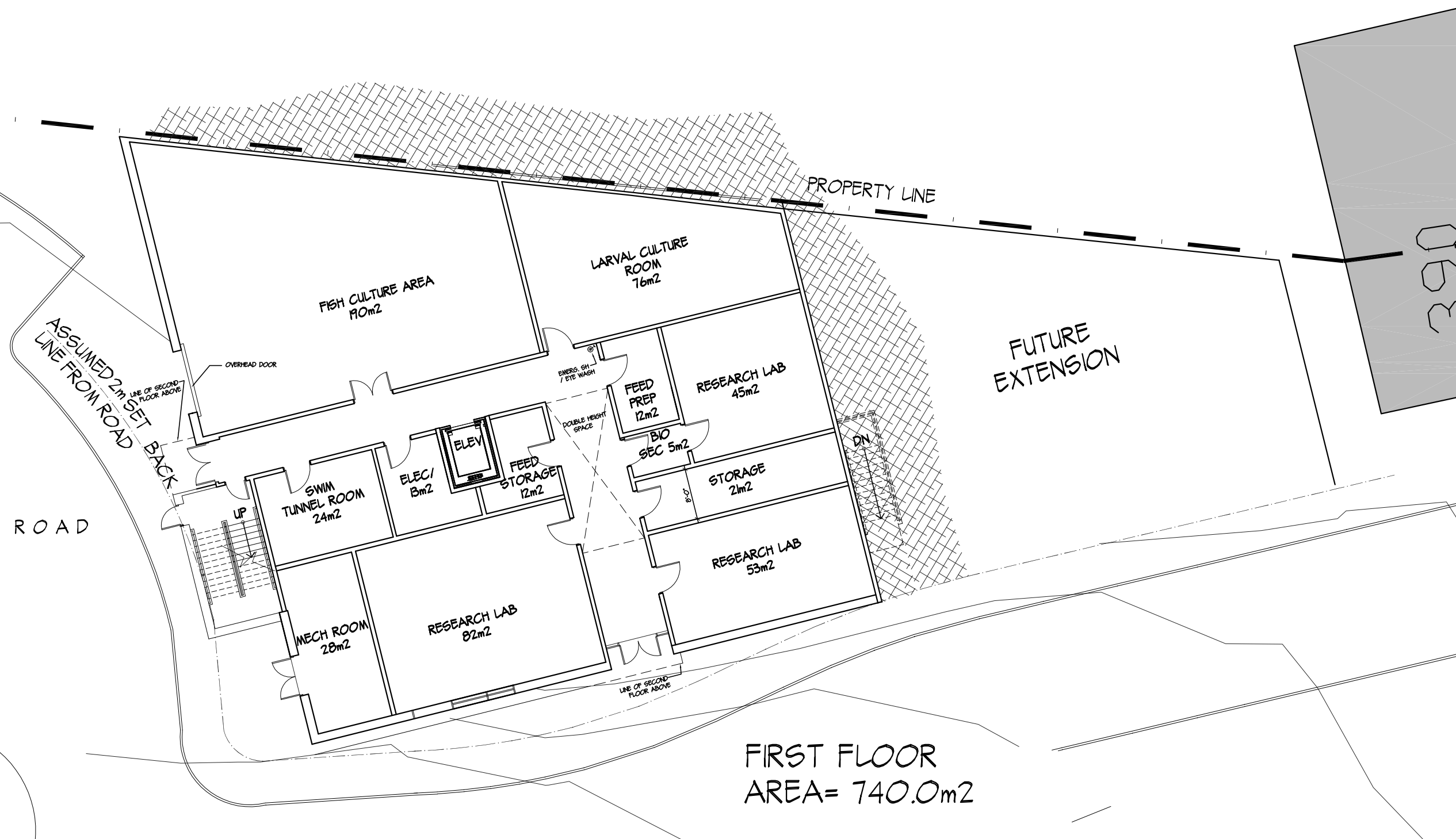

FIRST FLOOR
AREA= 740.0m²

FIRST FLOOR PLAN- OPTION B

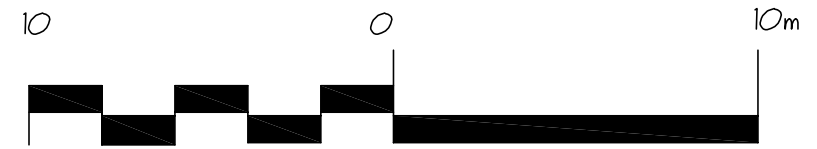

SCHEMATIC DESIGN

INTERNATIONAL CENTRE FOR STURGEON STUDIES
 CHERNOFF THOMPSON ARCHITECTS

SK-02

DRAWN = NM
 PROJECT No. = 2803.0
 SCALE = 1:200
 DATE = 08 OCT 08

420701-0001 22/09/08

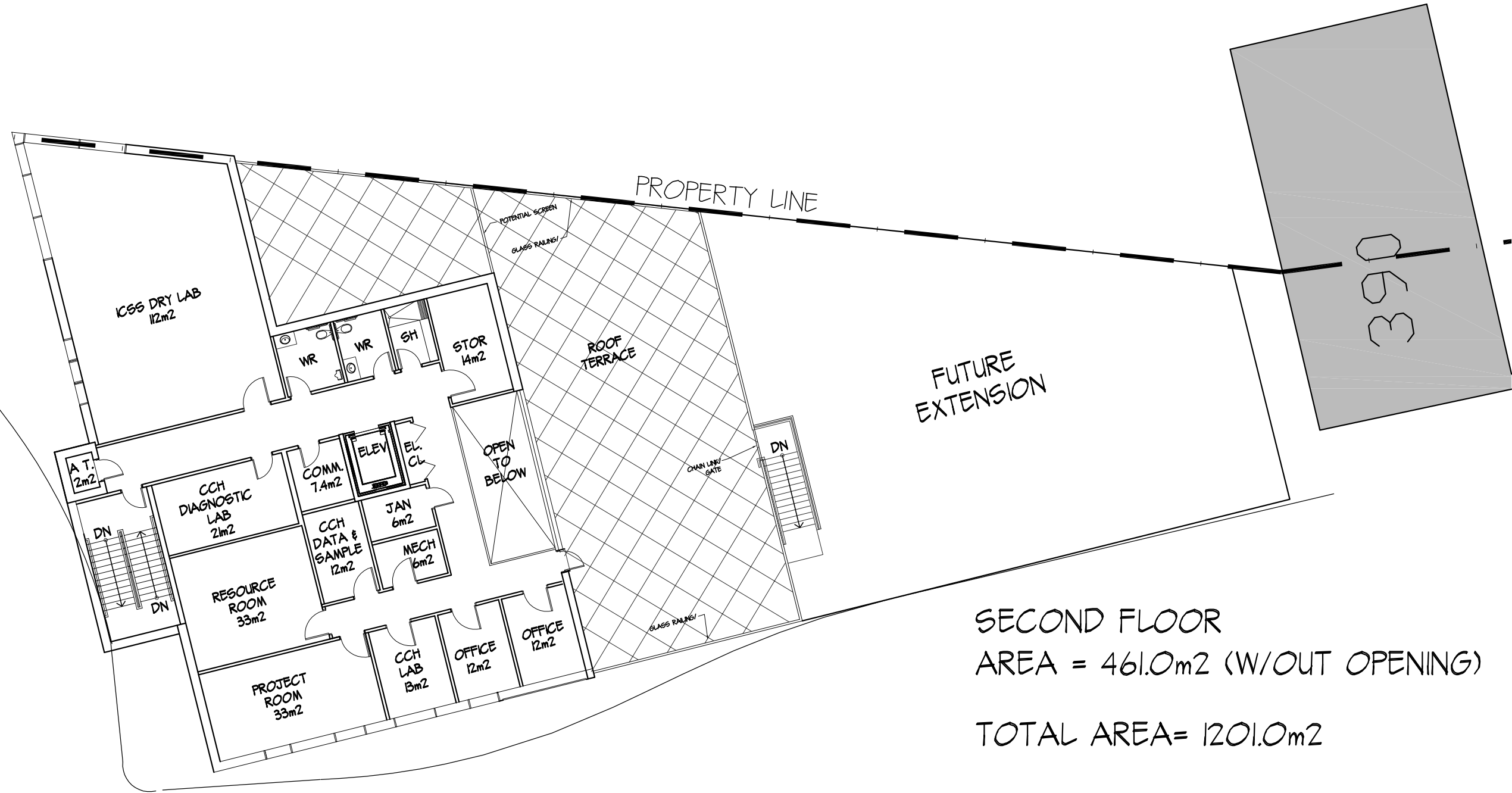

SECOND FLOOR
 AREA = 461.0m² (W/OUT OPENING)
 TOTAL AREA= 1201.0m²

SECOND FLOOR PLAN -OPTION B

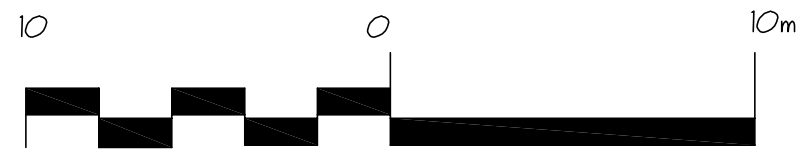

SCHEMATIC DESIGN

INTERNATIONAL CENTRE FOR SURGEON STUDIES
 CHERNOFF THOMPSON ARCHITECTS

SK-03

DRAWN = NM
 PROJECT No. = 2803.0
 SCALE = 1:200
 DATE = 08 OCT 08

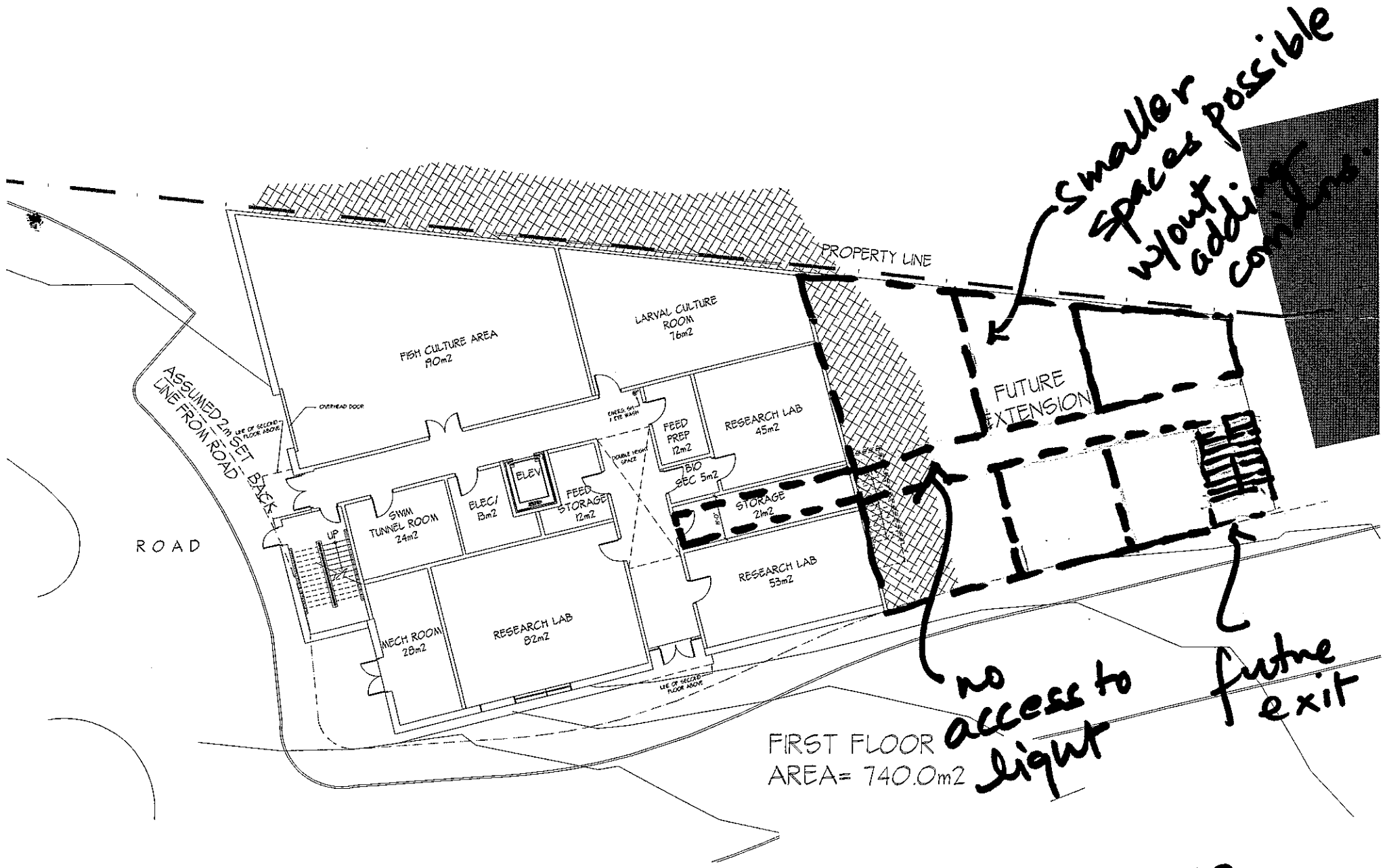

FIRST FLOOR
AREA = 740.0m²

Smaller spaces possible w/out adding concrete.

no access to light
future exit

OPTION 2.

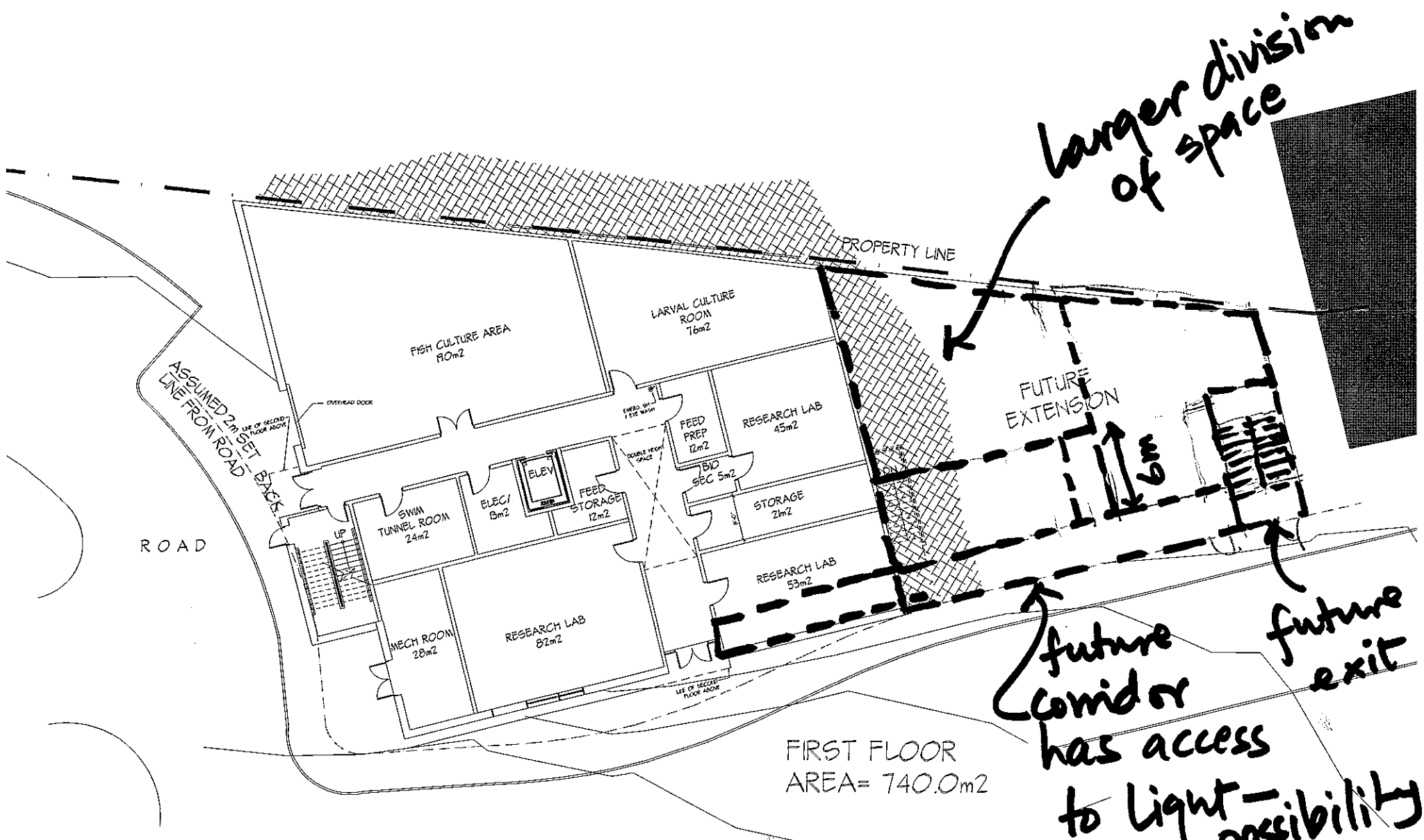

larger division of space

future corridor has access to light - possibility of a nice facade feature

future exit

OPTION 1